

LEGEND:

- =RF CDC OWNED
(Potential Building Area)
- =TOWN OWNED
(Potential Building Area)
- = PROPOSED PARK

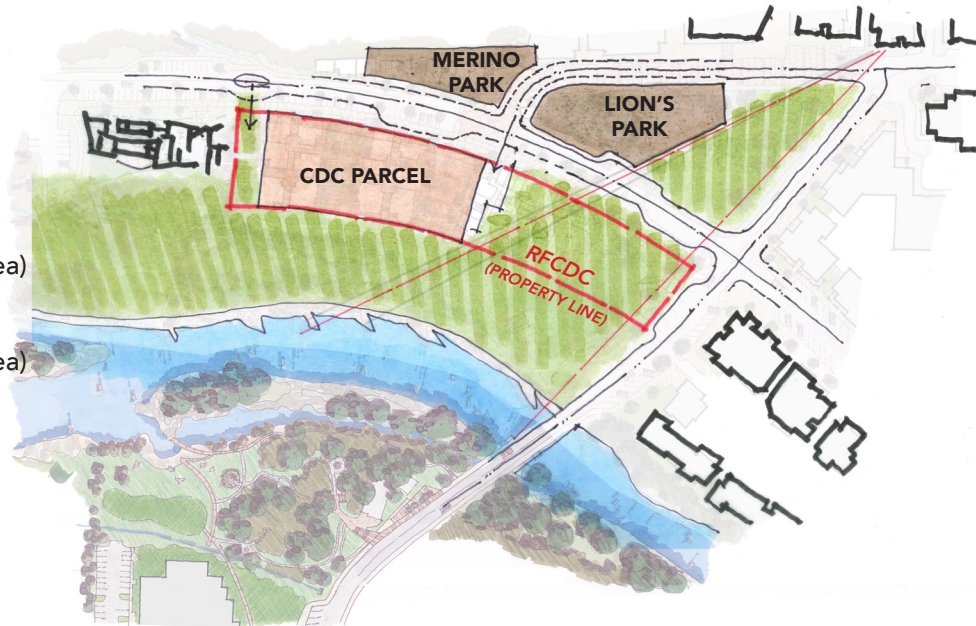

Option	CDC Parcel	Merino Park (Former Recycle Center)	Lion's Park	Total
3C	Gross Building Area = 75,000 sf Hotel + Townhomes or Flats (Approx. 40% Hotel - 60% Residential) Underground Parking	Gross Building Area = 19,500 sf Townhomes or Flats Tuck-Under Parking	Gross Building Area = 24,000 sf Mixed-Use: Non-Profit, Government, and Flats Underground Parking	118,500 gsf
3E	Gross Building Area = 75,000 sf Hotel + Flats (Approx. 40% Hotel - 60% Residential) Underground Parking	Gross Building Area = 19,500 sf Same as Above	Gross Building Area = 24,000 sf Same as Above	118,500 gsf
4D	Gross Building Area = 62,000 sf Hotel Cabins + Flats Underground Parking	Gross Building Area = 19,500 sf Same as Above	Gross Building Area = 54,000 sf Mixed-Use: Hotel, Non-Profit, and Flats Underground Parking	135,500 gsf



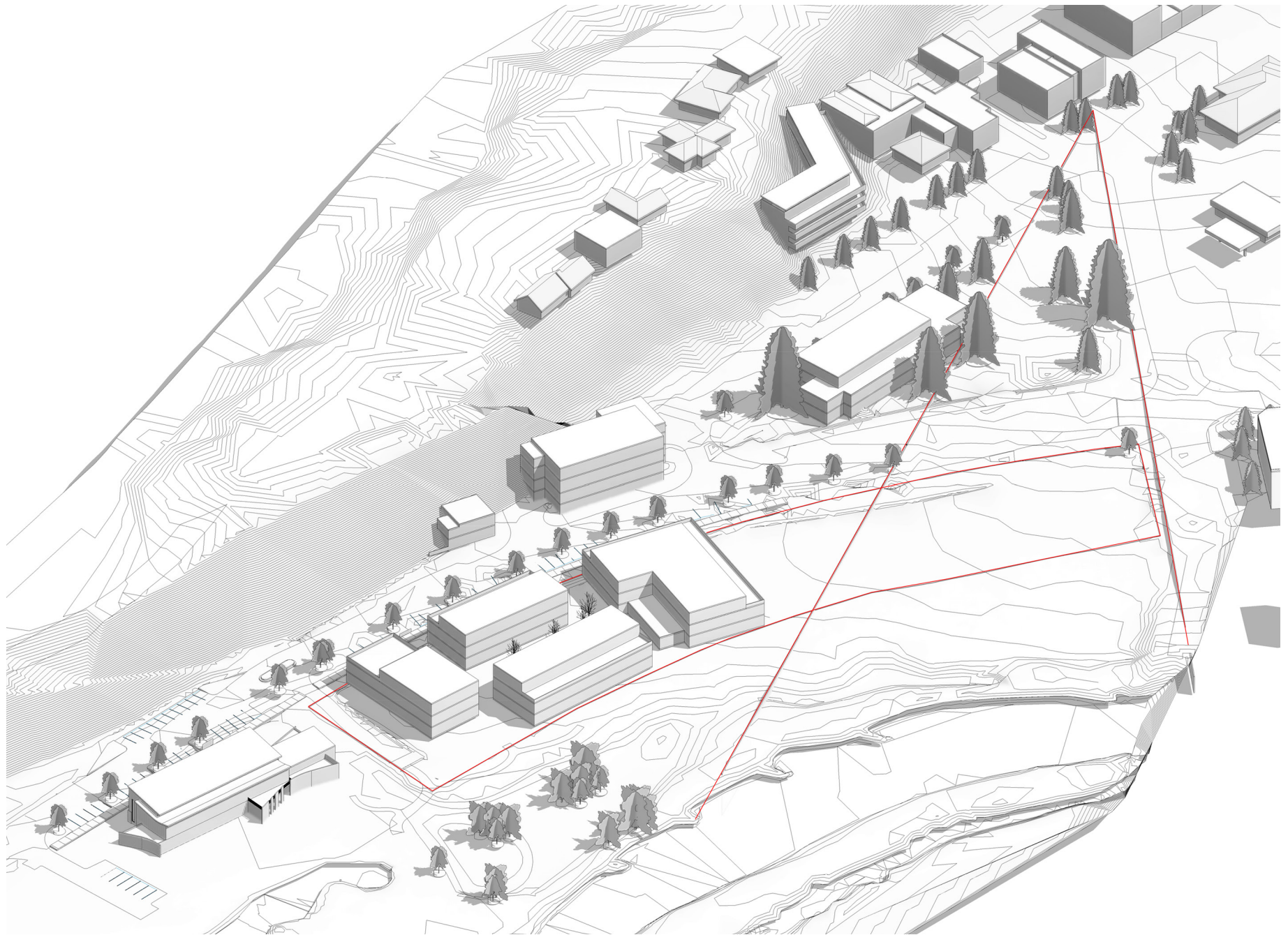

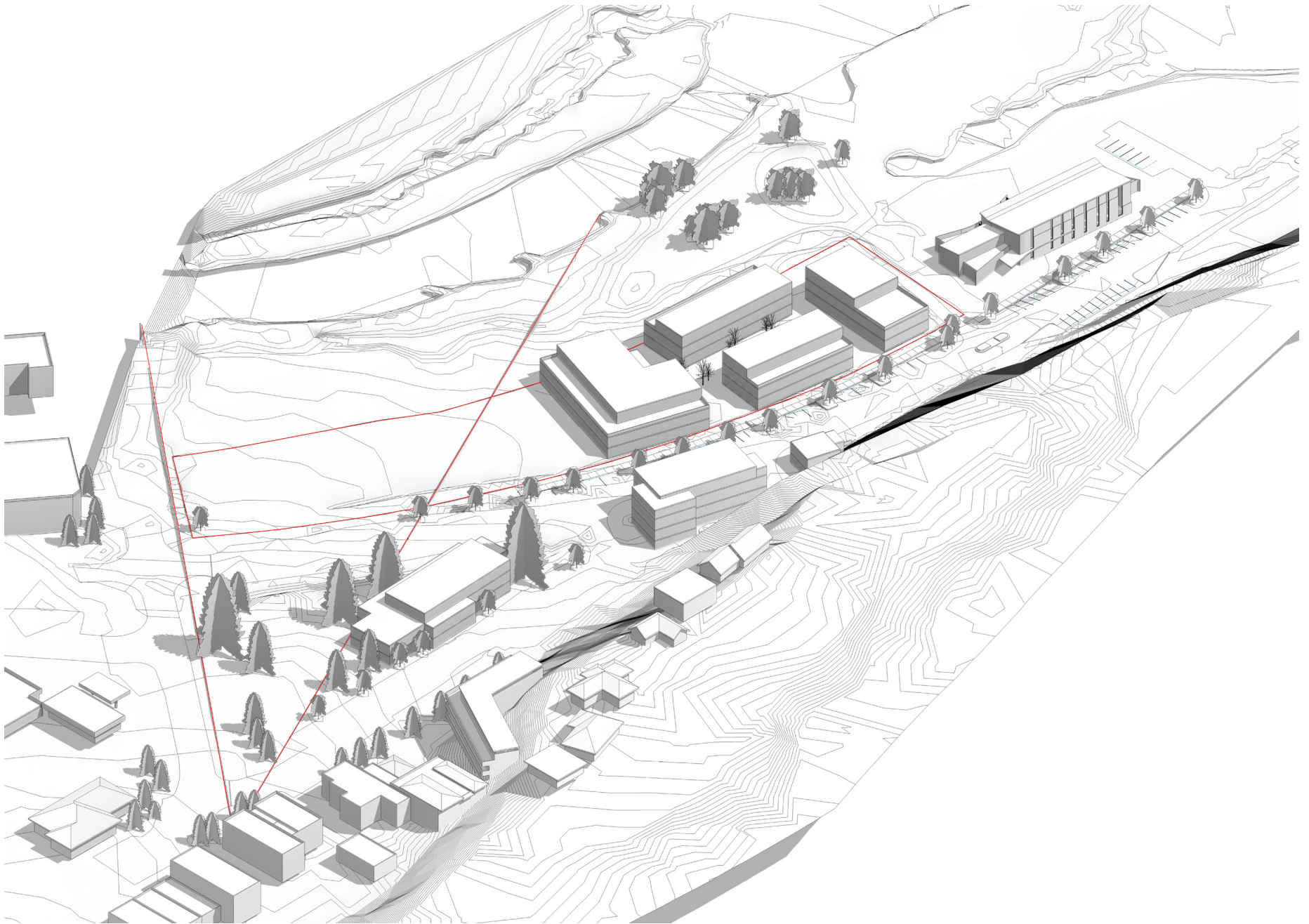



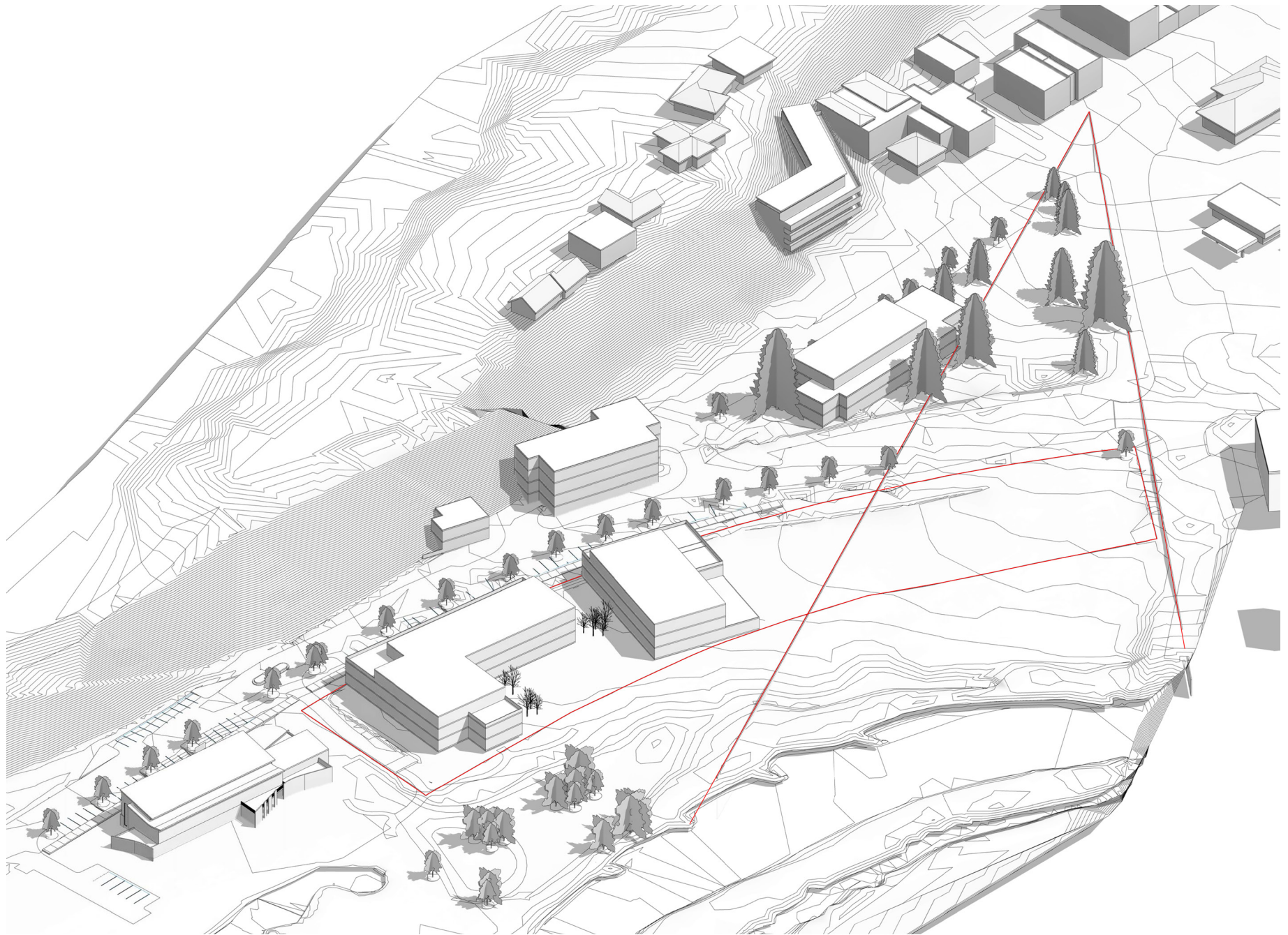

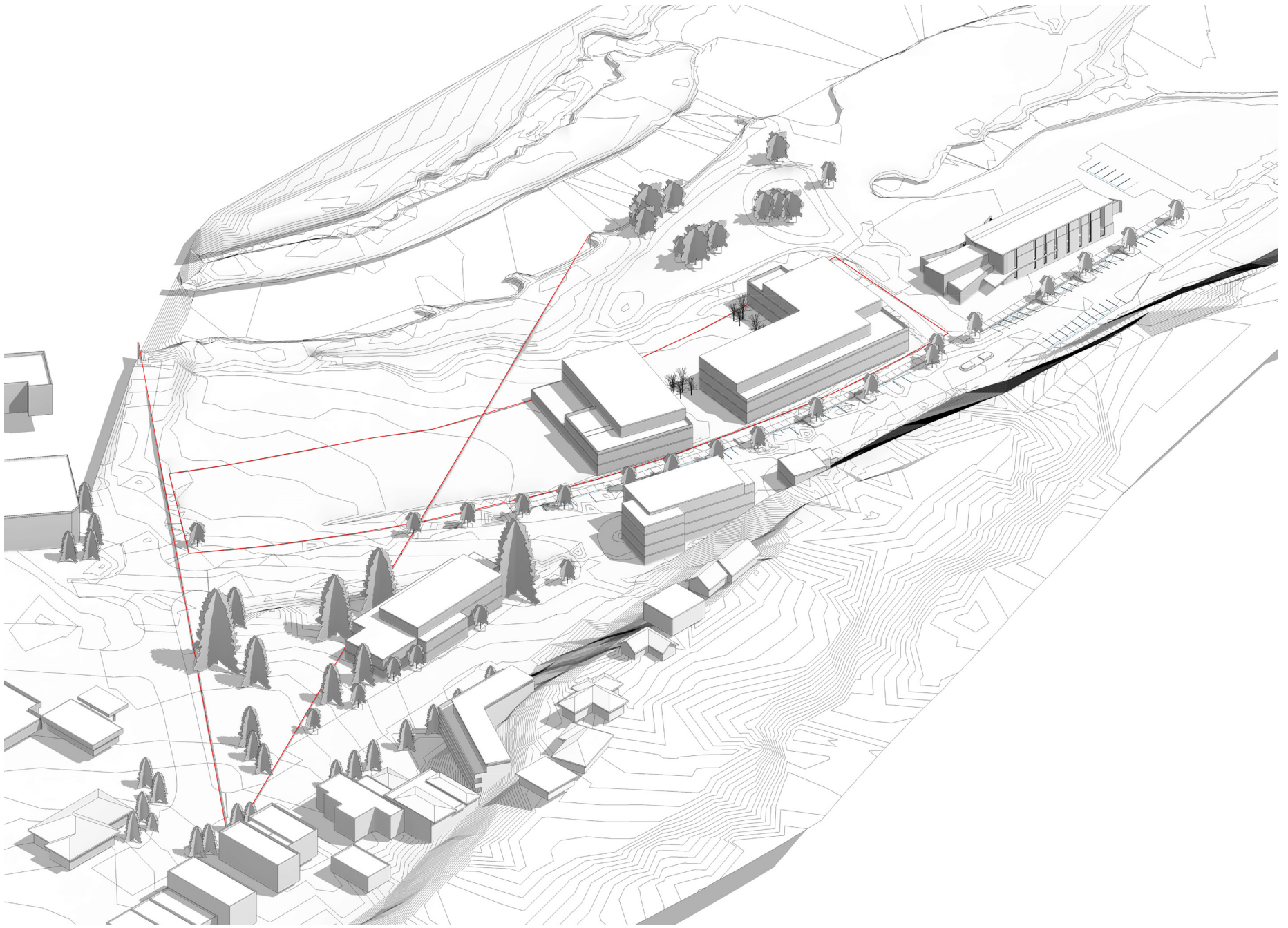



DRAFT