

E

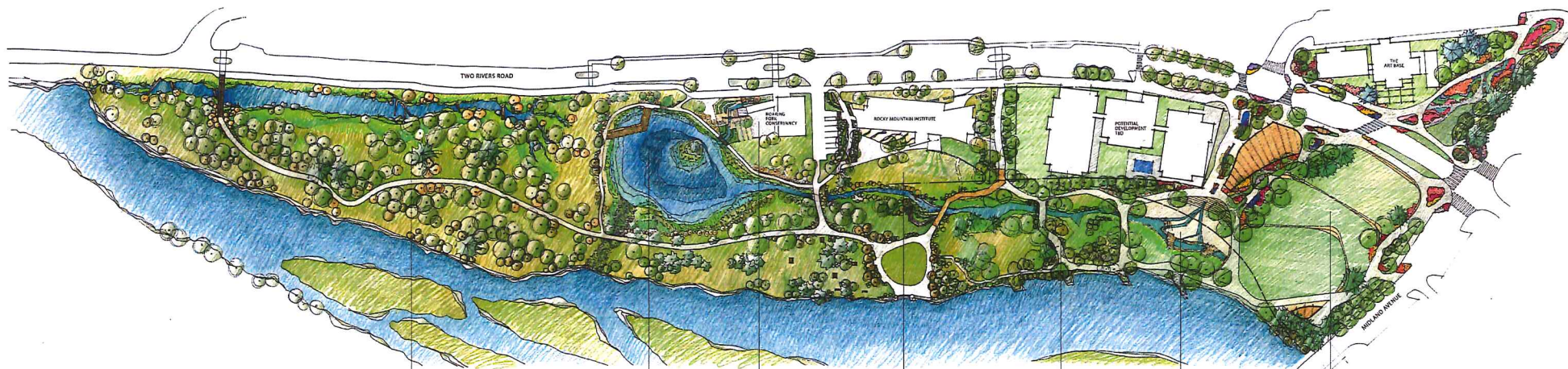

**BACKWATER PRESERVE**  
The wetlands in the natural preserve will be kept intact and exposed. The trail will create a continuous route along the river to town.

**OLD POND PARK / ROARING FORK CONSERVANCY**  
The Roaring Fork Conservancy is in the process of creating a new visitor and education center. Landscaping will include a wetland interpretative garden, viewing platform, open meadows, and access to the adjacent Old Pond Park. The wetland edge at Old Pond Park will be restored and enhanced, creating multiple areas for fishing access.

**ROCKY MOUNTAIN INSTITUTE / OLD POND PARK WATERFRONT**  
The Rocky Mountain Institute building is complete. Landscaping for the Institute highlights waterfront as it moves off the roof through the meadows. Historic public access to the river will continue and has been used to include picnic areas, wetland gardens, trails and fishing access.

**PARK WETLANDS**  
Existing wetlands have been preserved. Through a series of boardwalks and walkways, the public will be able to better enjoy this fragile ecosystem.

**CHILDRENS PLAY AREA**  
Creek steps lead down to a children's play area created from cobble, sand, and a water feature.

**TOWN OF BASALT RIVER PARK**  
The Basalt River Park will allow for a diversity of activities, including a large event space, pavilion, play area, perennial garden, and river architecture. The park is designed to accept periodic flooding.







**BASE LEVEL IMPROVEMENTS INCLUDE:**  
Earthwork and civil infrastructure for future park  
build out, gravel pathways, sod, topsoil, irrigation  
and scaled back planting and park lighting.





**FULL PARK IMPROVEMENTS INCLUDE:**  
Children's play area and stream water feature extending from Two Rivers Road into the park, great lawn with stone terraces, gathering areas along the waterfront, additional boardwalk connection through wetland areas, full planting plan and park lighting.





LAWN WATER CHANNEL

CHILDREN'S PLAY AREA

STONE STEPS



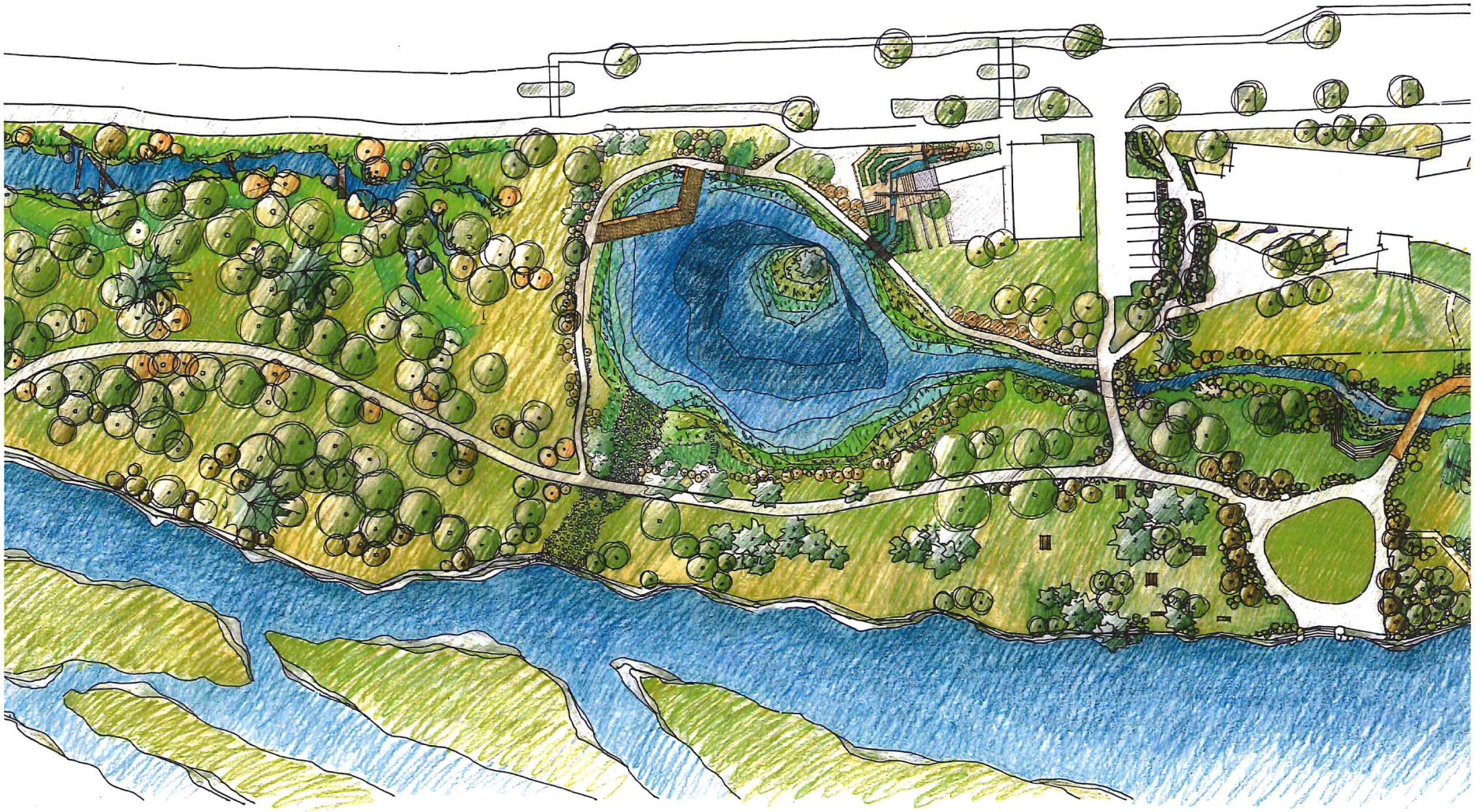



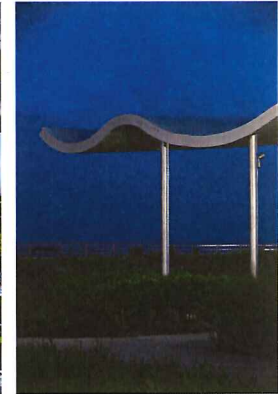
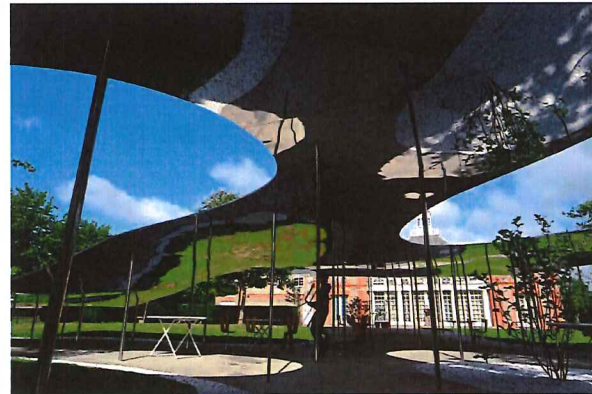

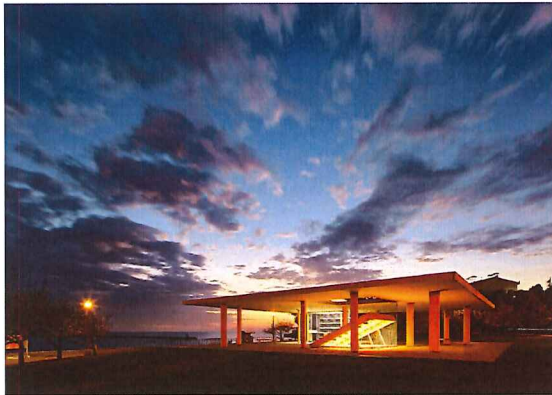

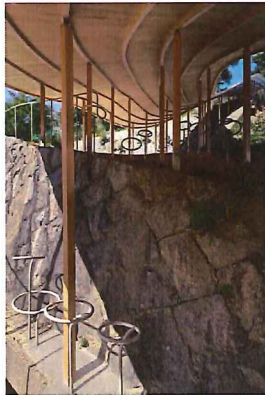



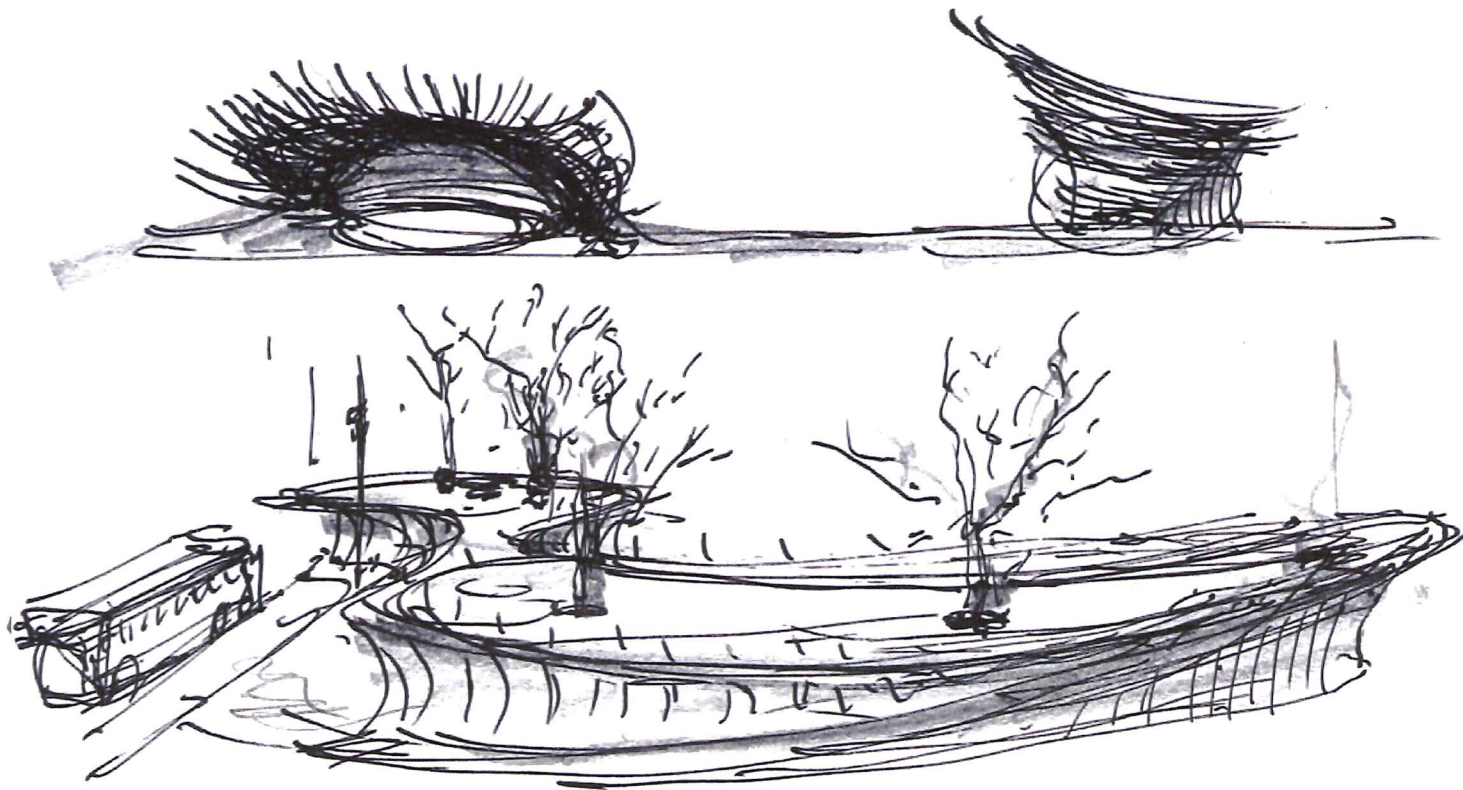



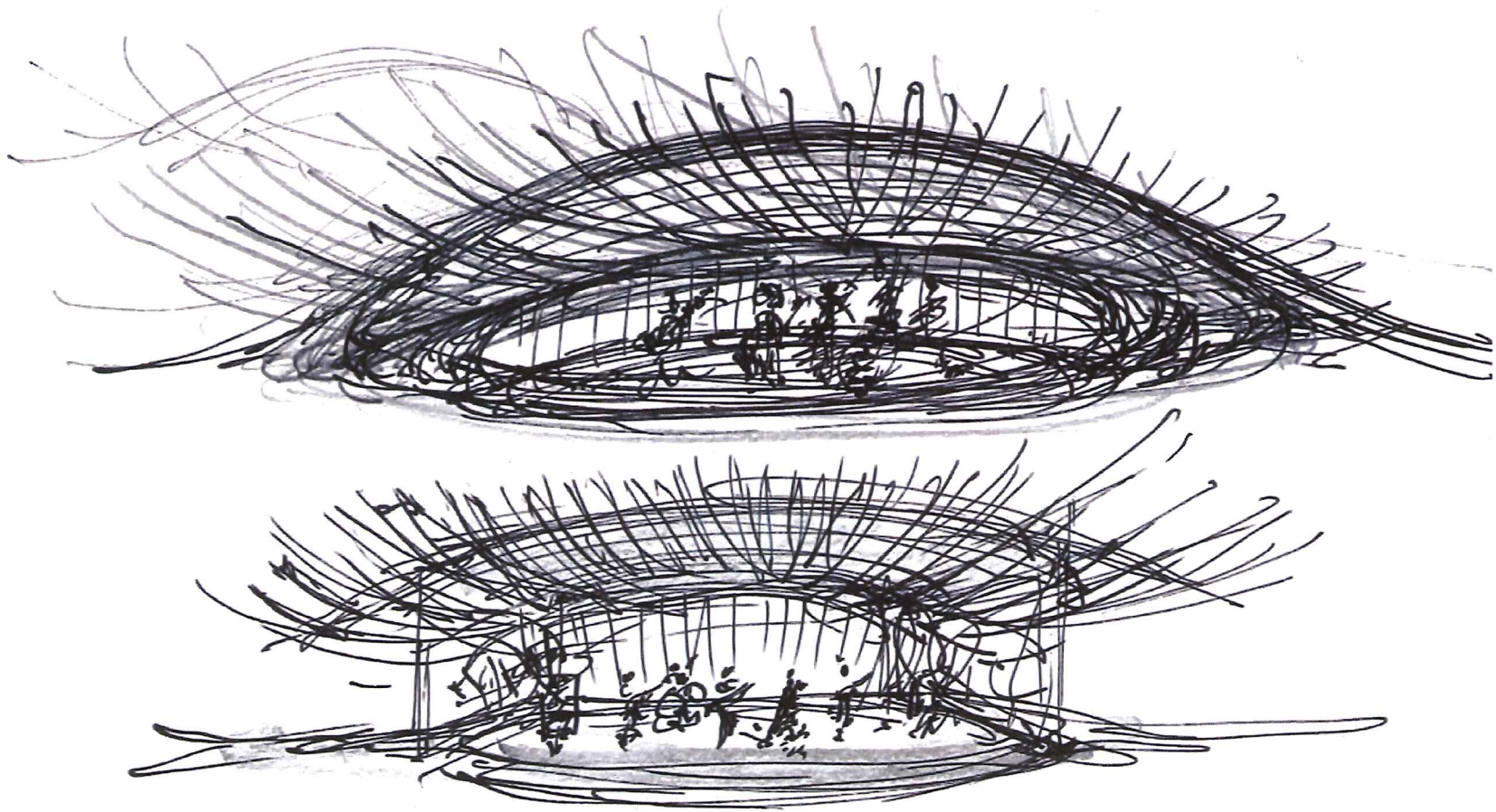





*Basalt River Park Band Shell*  
*5/10/16*







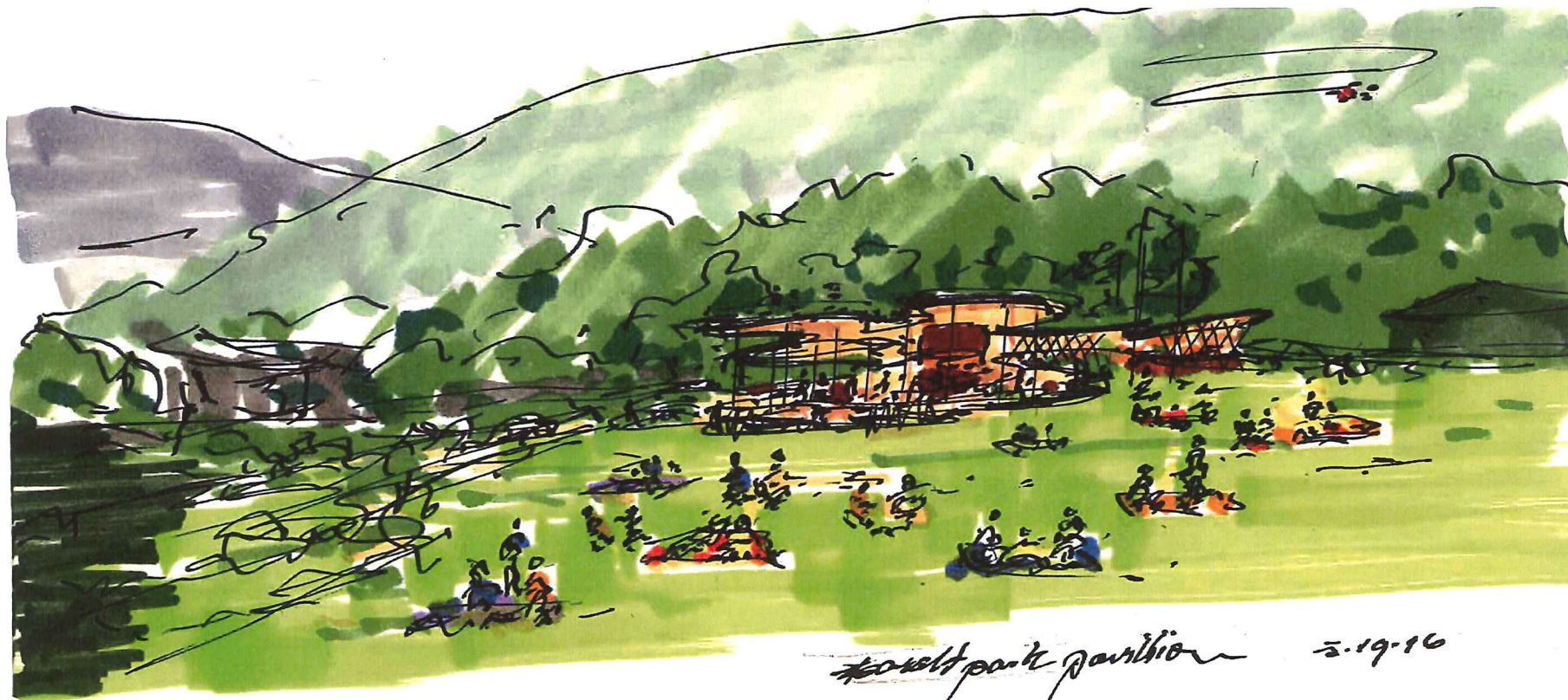

*basalt park pavilion 5.19.16*



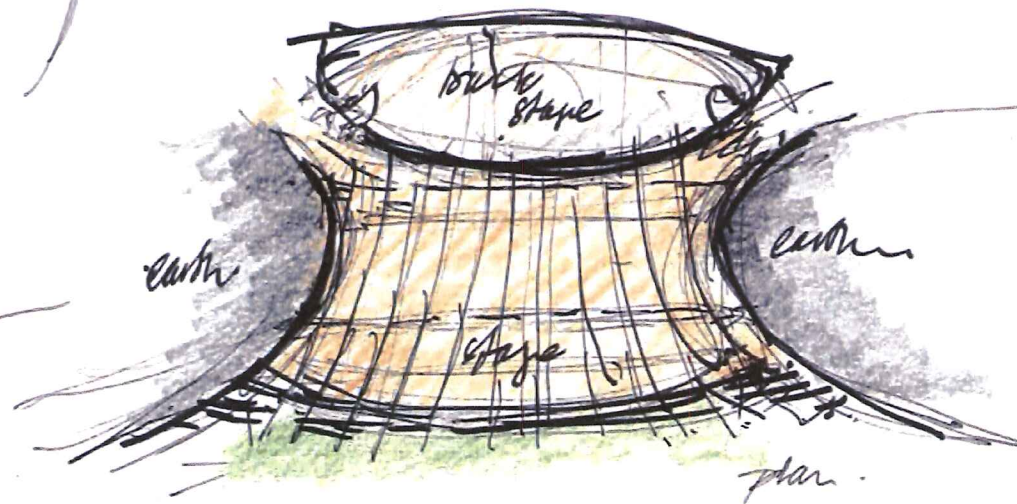
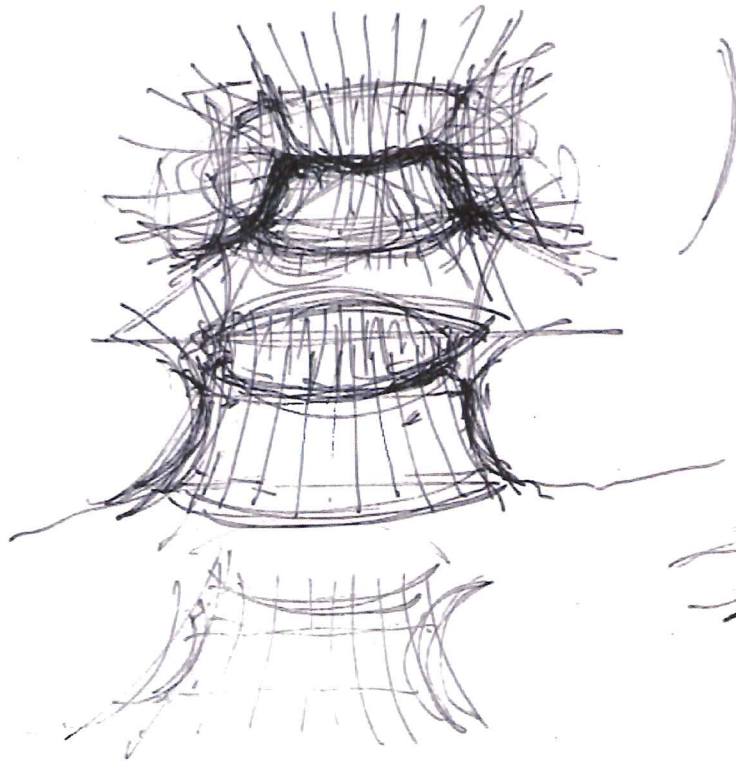

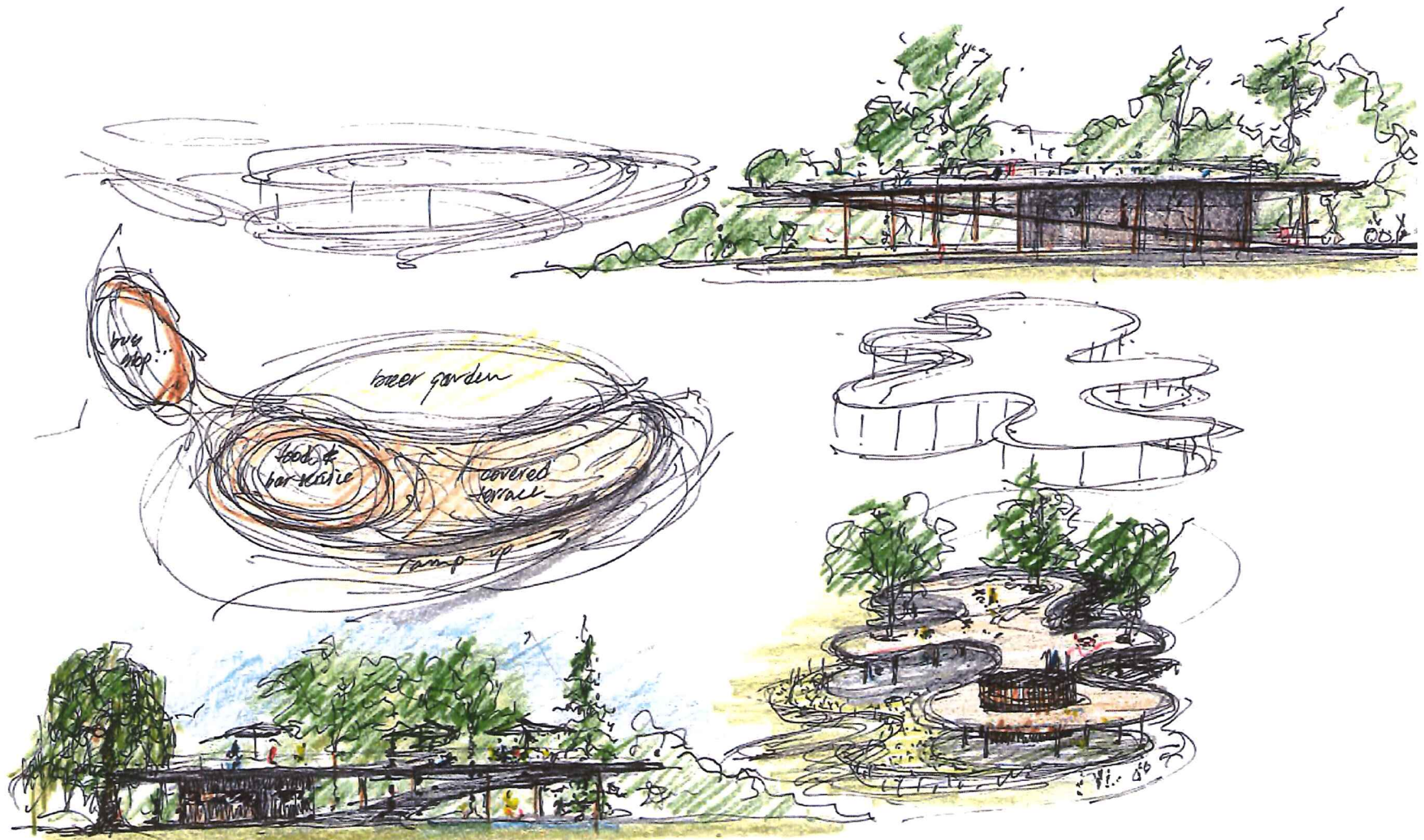







Basalt River Park Pavilion  
 upper deck 1"=20' 6.1.16